



Shavings

Hill Country Turners Monthly Newsletter



Volume #19

Issue #6 June 17, 2013

Next Meeting July 10, 2014 MEETING PLACE

Hill Country Turners meet in the basement of the KACC (Kerr Arts & Cultural Center) at 228 Earl Garrett, Kerrville, Texas at 6:00 pm on the 2nd Thursday of the month. The formal meeting starts at 6:30.

May Meeting

President, George Taylor called the meeting to order. Several guests were present. Will Aymond is healing well and will be receiving visitors soon. Expect him back next month. The club is getting help for an audio recorder that will help us

Upcoming Meeting Demos

July 10: George Taylor, Face Grain Boxes

August 20 (note date change): SWAT Regional woodturner, Don Leydens, and Beads of Courage Box Judging

September: Jamie Donaldson

Workshop

National woodturner, Jamie Donaldson, will hold a two one-day workshops **September 12 and 13** at Point Theater in Ingram. The workshop is only open to club members at the half price cost of \$50 per day. There are only 8 slots per day. John Stegall will take enrollment at the June meeting.

Open Shops Darrel Korman will host the July Open Shop. **The Open Shop will be on July 12, at 11:00 am.** Darrell expressed his plans and is eager to see us. The directions to his shop are repeated on the last page of this newsletter.

Southwest Association of Turners (SWAT)

The 2014 Symposium will be held **August 22 - 24**. The Regional demonstrators have been selected. National and Regional demonstrators can be viewed online (www.swaturners.org). The symposium is well worth the price of admission.

Please Note: SWAT-We are sponsoring a room this year and will need to have volunteers to sign up for one rotation as room hosts to take care of general stuff for the room and demonstrator (turning on the video, adjust camera as well as possible for the program, introduce the demonstrator etc.) The club needs at least one volunteer per rotation and two is best. Registration has begun. Registration can be done online (www.swaturners.org/registration). Applications can be also be submitted by mail (info also on the registration webpage). Individual pre-registration is \$140. July 31st is the last day you can pre-register online (July 25th for mail in registration). After that there is only on-site registration and the price goes up to \$170 for individual registration. Other prices (for spouses, students, one day passes) are also on the registration webpage.

The **4th Segmenting Symposium** will be held **October 16-19** in San Antonio. Details of the symposium can be found on the Segmented Turners website (www.segmentedwoodturners.org/symposium.php).

Other Local Events

The Hill Country Arts Festival will be held **October 10-12** at Point Theater in Ingram.

The Mesquite Art Show will be held **October 10-12** in Fredericksburg at the Market Platz.

Volunteers Needed

-Volunteers are requested to help setup, tear down and clean up at the Jamie Donaldson Point Theater workshops September 12-13.

-We have been invited to produce a turning video for KACC. This is a great opportunity for introducing the general public to the club and turning in general. Volunteers are needed that are willing to invest their time and talent for the video. Volunteers with video experience and resources are also needed.

Club Orders

-The next Craft Supplies order will be placed in October. Club prices are 10% off, no tax and free shipping with a minimum order of \$1000. Contact Will or George to place an order.

-The next Thompson Tool order will be placed after SWAT unless there are enough orders to meet the minimum before then. Club prices are 10% off, no tax and free shipping with a minimum order of \$1000. Contact Will or George to place an order.

Safety Tip of the month

High speed impresses no one. It's the end product that matters. Go at a comfortable speed.

Demo Notes: James Johnson, Sheer cutting and sheer scraping.



James worked on a prepared bowl blank that was ready for final turning. He noted that, even though a tenon was present, as the bowl dried and became oval, so did the tenon. You must start by truing the tenon so that it will provide an even grip to the chuck. Part of this process is to continue the truing cut to form a flat groove above the tenon for the end of the chuck jaws to rest on for proper grip.

James began by truing the side of the bowl blank with his bowl gouge held horizontal with the axis of the bowl as it turned. He pointed out that there was tear-out in the cross-grain areas. He pointed out that lots-and-lots of sanding could correct this, but better turning techniques would reduce or eliminate the tear-out, leaving much less sanding. The solution is the sheer cut.

James differentiated between a sheer cut and a sheer scrape. Both have their place. A sheer cut can be made with several different tools. Starting with a bowl gouge (swept-back grind) he placed the handle down at about 45° and presented the side of the gouge (see point “a” in fig. 1), rubbing the bevel, and slicing the fibers as fine as could be.

James went on to show that “straight” ground bowl gouges, spindle gouges (on the outside) and ½ round scrapers could be safely presented so as to rub the bevel and slice across the fibers. Even so, he pointed out that, occasionally, small ridges that were very hard to eliminate with this method could be reduced by sheer scraping. He showed a bowl that was ready for sanding at 220 grit by the combined use of shear cutting and scraping. He demonstrated the bowl gouge scraping technique of reversing the gouge and presenting one of the back wings (see point “b” in fig. 1) with the handle almost vertical.

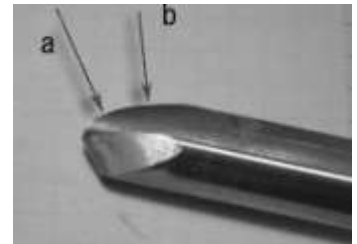

Demo Notes: Uel Clanton “Production Turning”



Uel turned a top and most of a jewelry platter to highlight the main process of preparation and standardization that mark the production turner's toolbox. Tops are made with a special collet that permits quick changes of pre-prepared Maple-dowel/Mesquite-disk blanks. When he is in the groove he can carve the top in forty seconds. It takes longer than that to sand and decorate the resulting top. He uses permanent Crayola color markers for the tops while still turning on the lathe. Tops get their final finish as a group.

The blanks for jewelry are larger mesquite disks about 6” in diameter and affixed to glue blocks marked for consistent placement on his chucks. He glues a narrow block, about 1 ½” , of a contrasting wood, such as cocobolo, in the center. He then can complete the whole

shaping of the upper part (ridges for the jewelry, center pole for rings) ready to finish. He parts the blank and holds it in a vacuum chuck for turning the bottom. For the demo, he turned a bottom and a top from separate blanks so we could see them formed and he will complete them later. Waste not, want not.

Show-and-Tell:

Roger Felps started off with two square edged bowls of Ambrosia Maple that took a long time to dry. One has a rim that rolls all the way down to the base of the bowl. He quipped “it was hard to bend in that shape”. Vern Hallmark has finally gotten his Locomotive Bank to his satisfaction. Of Walnut, Maple, Poplar, Pine and Ebony it is a joy to behold. Tom Canfield showed a Lidded bowl of Maple and Dyed Poplar. He used dark blue shoe polish for the dye to good effect.



Ken Morton showed an attractive little practice bowl of Big Leaf Maple with a hole that was a bark indentation. Harold Dykes asked if members could guess the source of the bowl on the left. It was Willow and the one on the right is mulberry with great sprayed lacquer finishes. George Taylor showed a work-in-progress. It will be the top of a Beads of Courage bowl and is of Poplar, Bubinga and Turquoise.



Roger Arnold brought a segmented bowl with over 200 pieces of Maple and Mahogany. He also was interested in seeing what a platter from “waffle board” would turn out like and he showed that.



2014 Food Sign-Up Sheet

Month	Meeting Date	Drinks	Sweets
July	10th	Uel Clanton	Martha Palmer
August	14th	John Stegall	Kathy & Jim Weir
September	11th	Joe Johnson	C. Herbert
October	9th	Jim Whisnand	John Jones
November	13th	Joe Johnson	George Taylor
December	11th	Christmas Party	Christmas Party

HCT Mentoring Program

It has always been a practice to encourage new members to visit in the shops of other members to help them get oriented to turning. Now we are offering for new turners a special list of members eager to help along with their area of interest. Even some less-than-new members who would like to talk to someone in a special area might take advantage of the help with special interests

The following members have volunteered to serve as Club Mentors. If you have a woodturning or tool/equipment question, call one of these individuals. They would be happy to help.

Name	Phone	Specialty	Name	Phone	Specialty
Roger Arnold	830-866-3670	Shop Practices	Uel Clanton	830-896-5288	General/Spindles
L. A. Cude	901-355-7046	Lacquer Finish	Chuck Felton	830-792-5249	General
James Johnson	830-895-4170	All	Joe Johnson	830-896-5924	General
John Jones	830-536-4503	General	K. Longnecker	830-257-6033	Split Turning/Pens
Ken Morton	210-833-7148	Natural Edge	Raul Pena	830-6342545	General

THE BIG CHIPS” of HCT 2014

President	George Taylor	(612)670-2607	gat54@mac.com
1 st Vice President	John Stegall	(830) 928-0859	jrstegall43@gmail.com
2 nd Vice President	Roger Arnold	(830)866-3670	arnwood@hctc.net
Treasurer	Will Aymond	(830) 285-2702	waymond@stx.rr.com
Secretary	Kathy Hampton	(830) 634-3002	Kathy@hamptonshop.com
Past President	Ken Morton	(830) 896-5924	ken@woodshouter.com
Special Events	Bill Hussey	(830) 896-8093	huzz@windstream.net
Newsletter/Webmaster	Jerre Williams	(830) 895-3206	jerrew@hotmail.com
KACC Liaison	Uel Clanton	(830) 896-5288	
SWAT Representative	Jim Whisnand	(830) 755-8603	jswhizcal@aol.com
Audio-Video Director	Tom Whiting	(443) 243-6933	twhiting@stx.rr.com
Website	http://www.hillcountryturners.org		

Hill country turners is a chapter of the American Association of Woodturners dedicated to providing education, information and a place to meet and discuss woodworking and woodturning.

4/12/2014

D. Korman

ampground

Untitled map

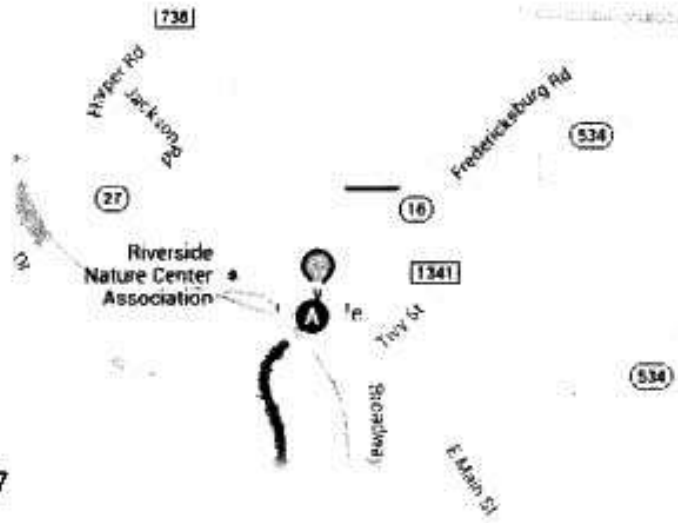

280 Bluebird Lane, Kerrville, TX 78028-8187
 6.95 miles /10 minutes

1. Start out going southwest on Sidney Baker St S / TX-16 toward Thompson Dr / TX-98-SPUR
2. Turn left onto Bandera Hwy/TX-173.
3. Turn right onto Saddle Club Dr. E.
4. Take the 1st right onto Bluebird Lane E.
5. **280 Bluebird Lane, Kerrville, TX 78028-8187.** Park on the concrete on the left side of the house or on the circular driveway. Enter the shop by going through the breeze way to the left of the house. Go through the man gate and into the first door on the left.

1.0 Mi
 5.6 Mi
 0.3 Mi
 0.1 Mi

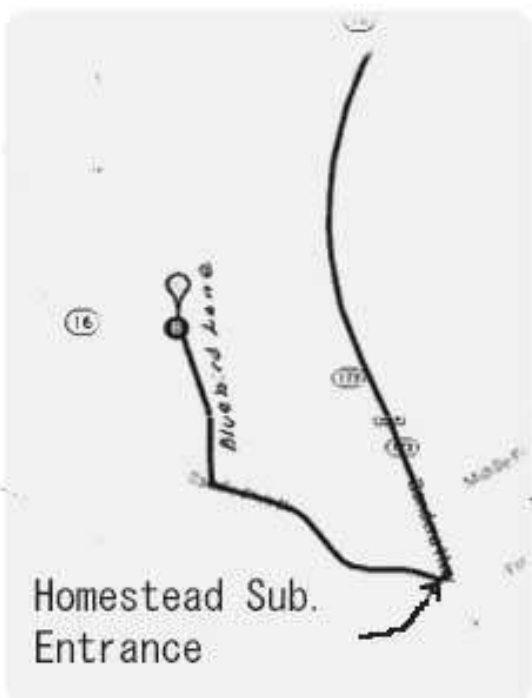

Homestead Sub.
 Entrance